

# Optoma Dual zone LED Installation guide

**WARNING:** Before commencing work on electrical connections please make sure that the mains power is isolated in the off position and secured so that it cannot accidentally be turned on. Always follow this guide.

**1** Remove the ballast cover by lifting it from one edge. You may need to loosen the screws at each end of the Optoma to enable the cover to move sufficiently.

**2** Mark the locations for the mounting screw keyholes ensuring the unit is level. Drill and insert screws leaving enough screw proud of the surface so they will protrude through the keyhole fixing.

NB: The final position of the unit is 4mm left or right of centre on the keyhole.

**3** Feed the mains cable into the unit from the back, through the rubber grommet as fitted.

Position the unit onto your prepared mounting screws, slide it left or right so the screws grip the unit securely. If necessary, the screws can be carefully tightened whilst in position.

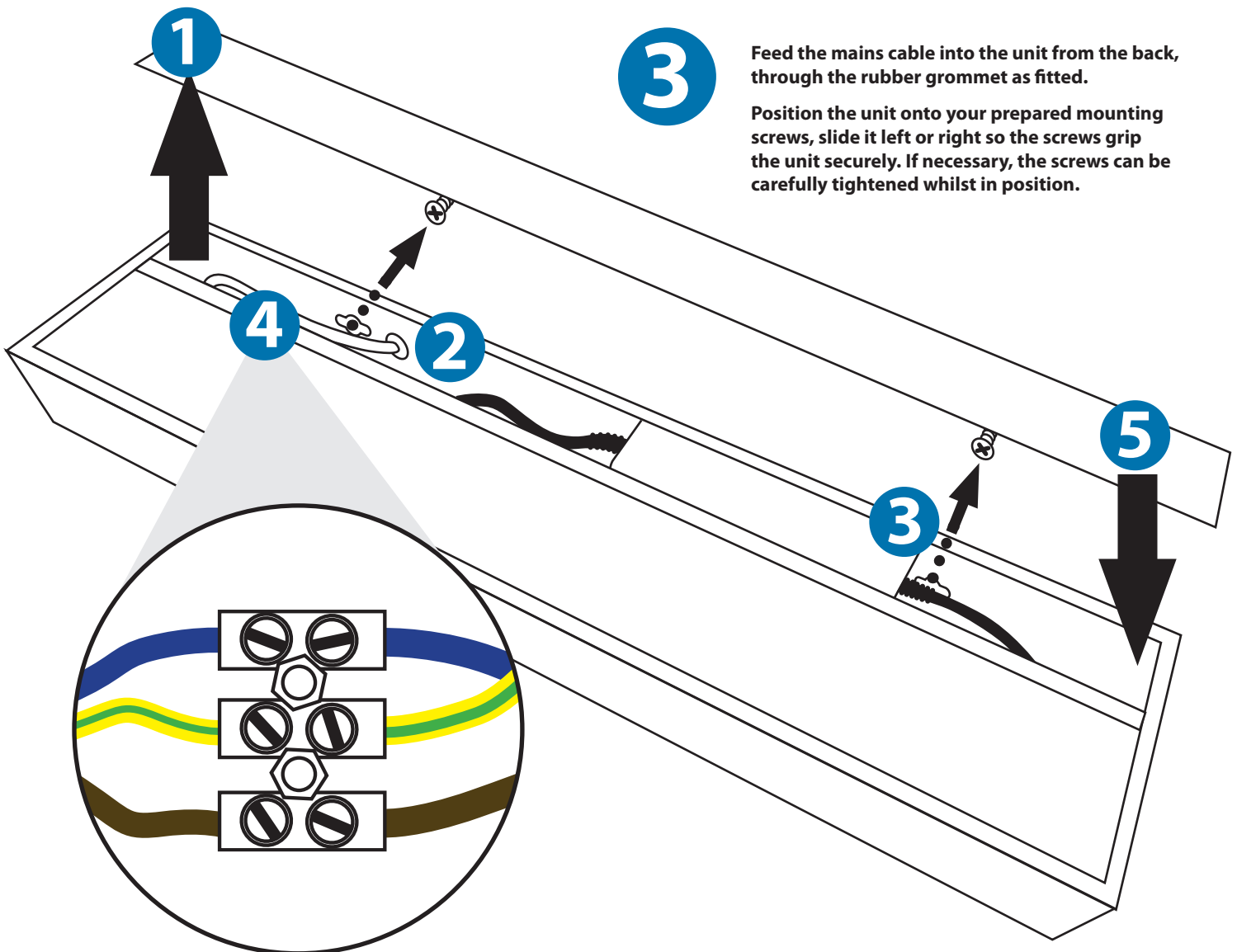

**4** Feed the mains cable through the grip and wire into the connector as shown left. Once connected secure the cable grip to prevent the mains cable pulling through.

**WARNING:** All cables connections must match. DO NOT CROSS POLARITIES, this could cause serious damage.

**5** Check the connections are correct, and that the unit is held securely by the keyhole fixings. Refit the ballast cover, retightening the screws on the end of the unit if you loosened them.

Turn on the power and check operation.

Your new Daray light is now ready to use.

For information on warranty details please visit [www.daray.co.uk/warranty](http://www.daray.co.uk/warranty)